



**LIFTING CHAIN AND COMPONENTS**





Beaver's range of lifting chain and components has been engineered with safety and quality in mind.

Beaver have developed and sourced the best lifting chain and components to ensure every facet of the lift is performed with effectiveness.

Our renowned industry brands are sourced from leading European manufacturers as well as Beaver's own range of Grade 80 lifting chain and components.

Our products are made with the highest calibre of materials to ensure unparalleled quality. Our products are designed and tested to meet the requirements of the Australian Standards.





# Contents

## LIFTING CHAIN AND COMPONENTS

BEAVER GRADE 80 LIFTING CHAIN AND COMPONENTS	7
BEAVER GRADE 80 – SINGLE AND DOUBLE LEG CHAIN SLINGS	8
BEAVER GRADE 80(T) CHAIN	10
BEAVER GRADE 80 MASTER LINK	10
BEAVER GRADE 80 COMPONENT CONNECTORS	12
BEAVER GRADE 100 LIFTING CHAIN AND COMPONENTS	22
BEAVER GRADE 100 – SINGLE AND DOUBLE LEG CHAIN SLINGS	24
MASTER LINKS AND SETS FOR G100 ASSEMBLY SYSTEMS	26
B-ALLOY-V WELD-ON LIFTING AND LASHING RINGS	35
B-ALLOY-V BOLT-ON LIFTING AND LASHING LUG	36
BEAVER GRADE 50 LIFTING CHAIN AND COMPONENTS	38
BEAVER GRADE 50 STAINLESS STEEL – CHAIN SLINGS	40
PRODUCT REFERENCE GUIDE	44

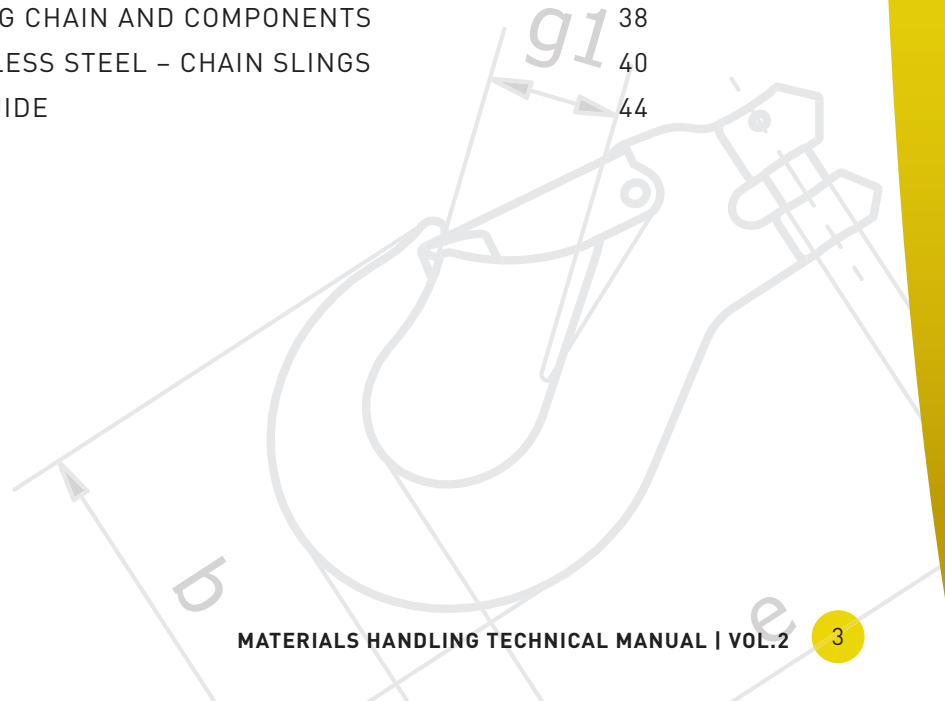

## BEAVER **B-Alloy Grade T(80) Chain Slings** TO AS 3775.2

CHAIN DIA. mm	SINGLE LEG SLINGS			SLINGS OF 2, 3 OR 4 LEGS				ENDLESS SLINGS	
	STRAIGHT SLING	ADJUSTABLE SLING	REEVED SLING	STRAIGHT SLING			REEVED SLING	BASKET SLING	REEVED SLING
				60°	90°	120°	60°	60°	
<b>MAXIMUM WORKING LOAD LIMITS IN TONNES OF 1000KG</b>									
6	1.1	0.8	0.8	1.9	1.6	1.1	1.5	1.5	1.7
7	1.5	1.1	1.1	2.6	2.1	1.5	2.0	2.0	2.3
8	2.0	1.5	1.5	3.5	2.8	2.0	2.6	2.6	3.0
10	3.2	2.4	2.4	5.5	4.5	3.2	4.1	4.1	4.8
13	5.3	4.0	4.0	9.2	7.5	5.3	6.9	6.9	8.0
16	8.0	6.0	6.0	13.8	11.3	8.0	10.4	10.4	12.0
20	12.5	9.4	9.4	21.6	17.6	12.5	16.3	16.3	18.8
22	15.0	11.3	11.3	26.0	21.2	15.0	19.5	19.5	22.5
26	21.2	15.9	15.9	36.7	29.9	21.2	27.6	27.6	31.8
32	31.5	23.6	23.6	54.5	44.4	31.5	41.0	41.0	47.3

### BEAVER ALLOY GRADE T(80) CHAIN SLINGS Care and Usage Instructions

**BEAVER ALLOY GRADE T(80) CHAIN SLINGS SHOULD ONLY BE USED BY A COMPETENT PERSON**

Maximum Working Load Limit in Tonnes of 1000kg, under general conditions of use.

- DO NOT EXCEED WORKING LOAD LIMIT
- DO NOT EXCEED 120°
- W.L.L. at 60° must never be exceeded, even at smaller angles.
- W.L.L. at other angles - apply the next greater angle and relevant load factor.

Extreme care should be taken when using the Beaver Grade T(80) Chain Slings in high temperature environments. It is therefore our instruction that the user must always err on the side of caution and make ample provisions for reduced Working Load Limits.

The following are our instructions:

#### ACIDIC CONDITIONS

Beaver Alloy Grade T(80) slings shall not be used in acidic solutions or in any other corrosive environment.

#### TEMPERATURE CONDITIONS

-10°C up to 200° C No reduction in W.L.L.  
200°C up to 300°C Reduce W.L.L. by 10%  
300°C up to 400°C Reduce W.L.L. by 25%  
**Do not use above 400°C**

#### GALVANISING

Beaver alloy chains and fittings should not be hot-dip galvanised or electro-plated, except by Beaver. Galvanised slings must always have the Working Load Limits reduced by 20%.

The W.L.L. of a sling must not exceed the lowest working load limit of the components in the system.

## Grade 100 & Grade 120 Chain Slings

**GRADE 100** **GRADE 120**

CHAIN DIA. mm	SINGLE LEG SLINGS			SLINGS OF 2, 3 OR 4 LEGS				ENDLESS SLINGS	
	STRAIGHT SLING	ADJUSTABLE SLING	REEVED SLING	STRAIGHT SLING			REEVED SLING	BASKET SLING	REEVED SLING
				60°	90°	120°	60°	60°	
<b>MAXIMUM WORKING LOAD LIMITS IN TONNES OF 1000KG</b>									
WIN 6	1.40	1.40	1.00	2.40	2.00	1.40	1.80	1.80	2.10
WIN 8	2.50	2.50	1.90	4.30	3.55	2.50	3.25	3.25	3.75
WINPRO 8	3.00	3.00	2.35	5.20	4.20	3.00	3.90	3.90	4.50
WIN 10	4.00	4.00	3.00	6.90	5.60	4.00	5.20	5.20	6.00
WINPRO 10	5.00	5.00	4.00	8.60	7.00	5.00	6.50	6.50	7.50
WIN 13	6.70	6.70	5.00	11.60	9.50	6.70	8.70	8.70	10.00
WINPRO 13	8.00	8.00	6.30	13.80	11.30	8.00	10.40	10.40	12.00
WIN 16	10.00	10.00	7.50	17.30	14.10	10.00	13.00	13.00	15.00
WIN 20	16.00	16.00	12.00	27.70	22.56	16.00	20.80	20.80	24.00
WIN 22	19.00	19.00	14.20	32.90	26.50	19.00	24.70	24.70	28.50
WIN 26	26.50	26.50	19.80	45.80	37.30	26.50	34.40	34.40	39.70
WIN 32	40.00	40.00	30.00	69.20	56.40	40.00	52.00	52.00	60.00

The load capacity listed are maximum values of various sling types, stated according to the standard (uniform load) method of rating similar to AS 3775

**GRADE 100 & 120 CHAIN SLINGS SHOULD ONLY BE USED BY A COMPETENT PERSON.**

Maximum Working Load Limit in Tonnes of 1000kg, under general conditions of use.

- DO NOT EXCEED WORKING LOAD LIMIT
- DO NOT EXCEED 120°
- W.L.L. at other angles - apply the next greater angle and relevant load factor.

#### SAFETY WARNING OF HAZARDOUS CONDITIONS:

Extreme care should be taken when using the Beaver Grade 100 & 120 Chain and fittings in high temperature environments. It is therefore our instruction that the user must always err on the side of caution and NEVER EXCEED 200°C

\*If the grab hook comes with suitable wing, no reduction factor is required, otherwise W.L.L. should be reduced by 25%

## Grade 50 Stainless Steel Chain Slings TO AS 4797

CHAIN DIA. mm	SINGLE LEG SLINGS		SLINGS OF 2, 3 OR 4 LEGS			ENDLESS SLINGS		
	STRAIGHT SLING	REEVED SLING	STRAIGHT SLING			REEVED SLING	BASKET SLING	REEVED SLING
			60°	90°	120°	60°	60°	
<b>MAXIMUM WORKING LOAD LIMITS IN TONNES OF 1000kg</b>								
5	0.50	0.40	0.85	0.70	0.5	0.85	0.68	0.80
7	1.00	0.80	1.70	1.40	1.0	1.70	1.36	1.60
10	2.00	1.60	3.40	2.80	2.0	3.40	2.72	3.20
13	3.20	2.56	5.44	4.48	3.2	5.44	4.35	5.12
16	5.00*	4.00	8.50*	7.00*	5.0*	8.50*	6.80	8.00

\*10% Reduction with HSK16

**Grade 50 chain slings should only be used by a competent person.**  
**Maximum Working Load Limit in tonnes of 1000kg, under general conditions of use.**

- Do not exceed Working Load Limit
- Do not exceed 120°
- WLL at other angles – apply the next greater angle and relevant load factor
- Never exceed 200°C







**G80(T) LIFTING CHAIN AND COMPONENTS**

## BEAVER GRADE 80 LIFTING CHAIN AND COMPONENTS

### Beaver Grade 80 (T) Lifting Chain

Beaver Grade 80 (T) Chain is manufactured from heat treated alloy steel and is ideal for heavy duty lifting applications. It meets Australian standard AS 2321, Short-Link Chain for Lifting Purposes and is high strength, rugged, versatile and low-weight.

- Quality testing is done throughout the manufacturing process
- Beaver Grade 80 Chain also carries the marks “BN-8” or “BSN-8” stamped at intervals along its entire length for easy identification

### Beaver Grade 80 Components

Beaver Grade 80 Lifting Components are manufactured from heat treated alloy steel and are ideal for heavy duty lifting applications. They meet Australian standard AS 3776, Lifting Components for Grade T Chain Slings.

- Quality testing is undertaken throughout the manufacturing process
- Beaver Grade 80 Components also carry distinguishing marks – see below image 1.1

**Image 1.1 Grade 80 Component markings**

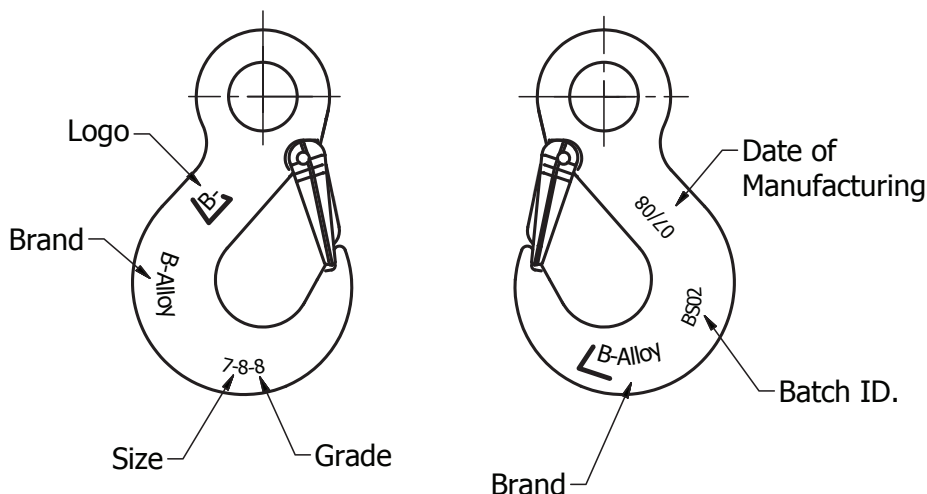

## BEAVER GRADE 80 – SINGLE AND DOUBLE LEG CHAIN SLINGS

### Beaver Grade 80 Single Leg Sling with Clevis Sling Hook

*c/w Safety Latch & Shortening Grab Hook– AS 3775.1*

Code	Chain Size mm	Effective Length mtr	W.L.L No Deration (kg)
CSA07117525	7	1	1500
CSA07127525	7	2	1500
CSA07137525	7	3	1500
CSA08117525	8	1	2000
CSA08127525	8	2	2000
CSA08137525	8	3	2000
CSA10117525	10	1	3200
CSA10127525	10	2	3200
CSA10137525	10	3	3200



### Beaver Grade 80 Double Leg Sling with Clevis Sling Hook

*c/w Safety Latch & 2 Shortening Grab Hook– AS 3775.1*

Code	Chain Size mm	Effective Length mtr	W.L.L @ 60° No Deration (kg)
CSA07217525	7	1	2600
CSA07227525	7	2	2600
CSA07237525	7	3	2600
CSA08217525	8	1	3500
CSA08227525	8	2	3500
CSA08237525	8	3	3500
CSA08247525	8	4	3500
CSA08267525	8	6	3500
CSA10217525	10	1	5500
CSA10227525	10	2	5500
CSA10237525	10	3	5500
CSA10247525	10	4	5500
CSA10267525	10	6	5500
CSA13217525	13	1	9200
CSA13227525	13	2	9200
CSA13237525	13	3	9200
CSA13247525	13	4	9200





## Beaver Grade 80 Single Leg Sling with Clevis Self Locking Hook

*c/w Shortening Grab Hook- AS 3775.1*

Code	Chain Size mm	Effective Length mtr	W.L.L No Deration (kg)
CSA07117545	7	1	1500
CSA07127545	7	2	1500
CSA07137545	7	3	1500
CSA08117545	8	1	2000
CSA08127545	8	2	2000
CSA08137545	8	3	2000
CSA10117545	10	1	3200
CSA10127545	10	2	3200
CSA10137545	10	3	3200



## Beaver Grade 80 Double Leg Sling with Clevis Self Locking Hook

*c/w 2 Shortening Grab Hook- AS 3775.1*

Code	Chain Size mm	Effective Length mtr	W.L.L @ 60° No Deration (kg)
CSA07217545	7	1	2600
CSA07227545	7	2	2600
CSA07237545	7	3	2600
CSA08217545	8	1	3500
CSA08227545	8	2	3500
CSA08237545	8	3	3500
CSA08247545	8	4	3500
CSA08267545	8	6	3500
CSA10217545	10	1	5500
CSA10227545	10	2	5500
CSA10237545	10	3	5500
CSA10247545	10	4	5500
CSA10267545	10	6	5500
CSA13217545	13	1	9200
CSA13227545	13	2	9200
CSA13237545	13	3	9200
CSA13247545	13	4	9200



## BEAVER GRADE 80 (T) CHAIN

### Grade T(80) Alloy Chain to AS 2321

Code	Size mm	S mm	R mm	F mm	W.L.L tonnes	UOM	Metres Per 100kg
148006	6	6	18	22.2	1.2	Metre	115
148007	7	7	21	25.9	1.6	Metre	90
148008	8	8	24	29.6	2	Metre	71
148010	10	10	30	37	3.2	Metre	45
148013	13	13	39	48.1	5.4	Metre	26
148016	16	16	48	59.2	8.2	Metre	17
148020	20	20	60	74	12.8	Metre	11
148022	22	22	66	81.4	16	Metre	9
148026	26	26	78	96.2	20.6	Metre	6
148032	32	32	96	118	32.8	Metre	4

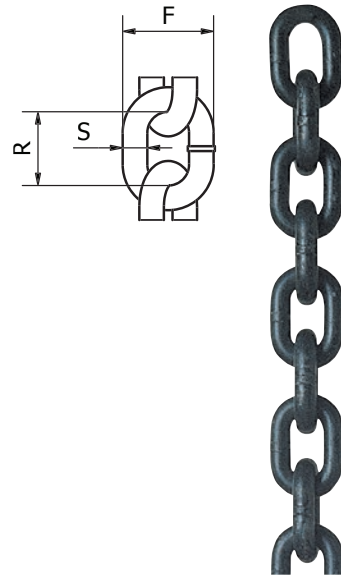

## BEAVER GRADE 80 MASTER LINK

### Beaver Grade 80 Recessed Enlarged Master Oblong Link

Code	Chain Size mm		W.L.L (kg)	S mm	R mm	F mm	T mm	Approx Weight (kg)	UOM	Pack Qty
	1 Leg	2 Leg								
883508A	8	7	2700	15.5	120	70	7	0.44	Each	60
883510A	10	8	3500	18	140	80	7	0.67	Each	25
883513A	13	10	5500	22.5	160	95	11	1.52	Each	16
883516A	16	13	9400	29	190	110	13	2.65	Each	8
883520A	20	16	14200	35	230	130	16	4.48	Each	6
883522A	22	20	22300	42	275	150	22	7.49	Each	3
883526A	26	22	33500	50	340	180	28	12.83	Each	2
883532A	32	26	40800	55	350	190	30	16.56	Each	1
883536A	36	32	56800	62	400	200	36	31.02	Each	1

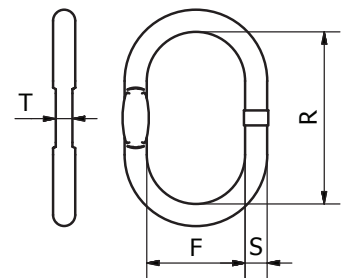

*Designed for Single & 2 Leg Applications*



## BEAVER GRADE 80 MASTER LINK (CONT'D)

### Beaver Grade 80 Recessed Enlarged Multi-Leg Master Oblong Link

Code	Chain Size mm	W.L.L (Ø60°) (kg)	S mm	R mm	F mm	T mm	E mm	s mm	r mm	f mm	t mm	Approx Weight (kg)	UOM	Pack Qty
883707	7	3150	19	135	75	-	195	13	60	38	8	1.35	Each	1
883708	8	4250	23	160	90	-	230	16	70	34	8	2.32	Each	1
883710	10	6700	27	180	100	-	265	18	85	40	11.5	3.58	Each	1
883713	13	11200	33	200	110	-	315	23	115	50	14	6.57	Each	1
883716	16	17000	36	260	140	-	400	27	140	65	18	10.3	Each	1
883720	19-20	26500	45	340	180	-	490	33	150	70	-	19.3	Each	1
883722	22	31500	50	350	190	-	520	36	170	75	-	25.1	Each	1
883726	26	45000	56	400	200	-	570	40	170	80	-	34.3	Each	1
883732	32	56800	70	460	250	-	660	50	200	100	-	64	Each	1

*Designed for 2, 3, 4 Leg Applications*

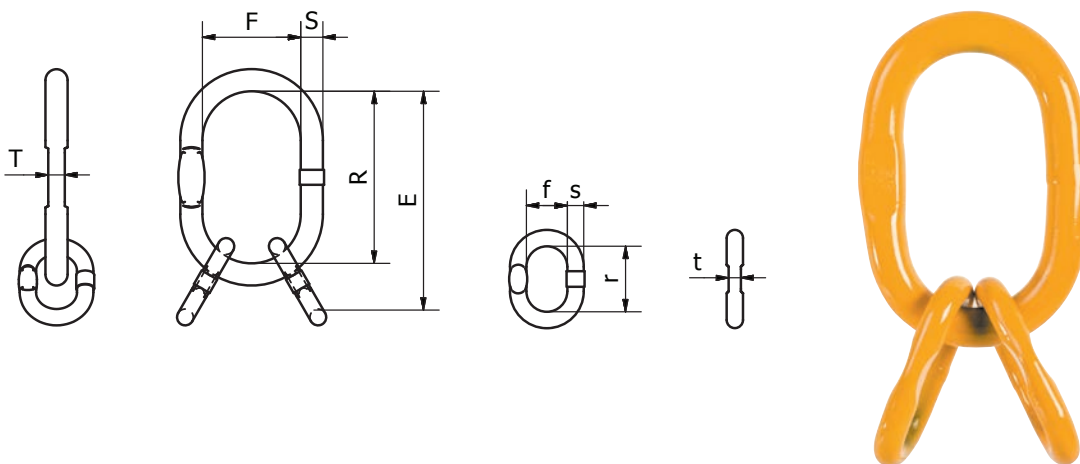

## BEAVER GRADE 80 MASTER LINK (CONT'D)

### Beaver Grade 80 Clevis Single Master Link

Code	Chain Size mm	W.L.L (kg)	e mm	b mm	h mm	h2 mm	d mm	f mm	s mm	Approx Weight (kg)	UOM	Pack Qty
882007	7-8	2000	138	92	163.7	105	9.7	9	16	0.7	Each	1
882010	10	3200	167	111	197	128	12	12	18	1.2	Each	1
882013	13	5300	203	134	241	150	16	15	22	2.3	Each	1
882016	16	8000	230	152	276	165	20	18	26	3.8	Each	1

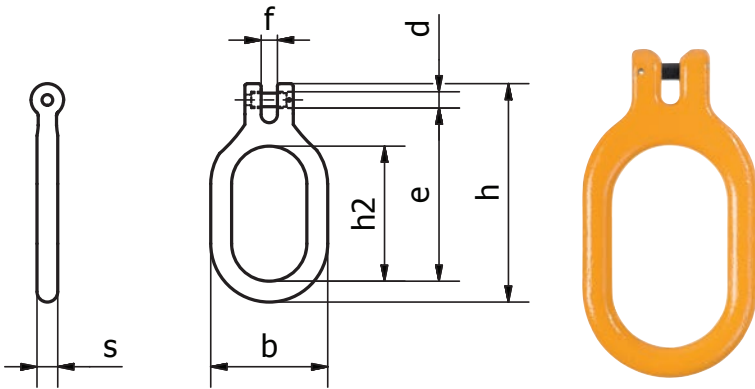

## BEAVER GRADE 80 COMPONENT CONNECTORS

### Beaver Grade 80 Component Connector

Code	Chain Size mm	W.L.L (kg)	b mm	c mm	e mm	g mm	d mm	s mm	Approx Weight (kg)	UOM	Pack Qty	Replacement Pin and Stud Kit
C6	6	1100	40	7	45	18	7.7	10.5	0.07	Each	20	894206BA
C7	7	1500	47	8.3	52	19	9	12.3	0.1	Each	30	894207BA
C8	8	2000	55	9.5	65	23	10.5	13.5	0.25	Each	20	894208BA
C10	10	3200	63	12	73	27	12.9	17.2	0.35	Each	30	894210BA
C13	13	5300	82	16	88	34	16.8	22.7	0.68	Each	20	894213BA
C16	16	8000	105	19	103	39	20.6	28	1.1	Each	12	894216BA
C20	20	12500	122	23.5	116	47	25.8	34.8	2.2	Each	8	894220BA
C22	22	15000	135	26.5	133	55	28.3	35.5	2.72	Each	6	894222BA
C26	26	21200	163	31.5	148	60	33.4	42	5.05	Each	4	894226BA
C32	32	31500	206	38	183	79	40.8	51	10.02	Each	2	894232BA

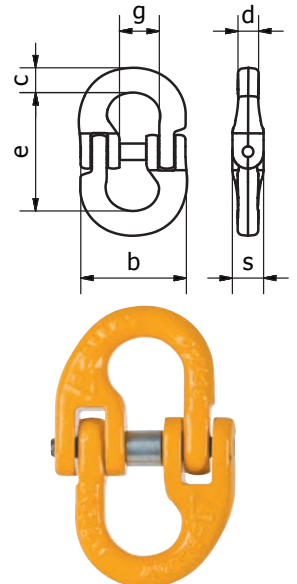



## BEAVER GRADE 80 COMPONENT CONNECTORS

### Beaver Grade 80 Clevis Clutch – Locking Type

Code	Chain Size mm	W.L.L (kg)	c mm	f mm	g mm	e mm	a mm	k mm	Approx Weight (kg)	UOM	Pack Qty
884510SY	10	3150	12	12	12	66	12	28	0.9	Each	1
884513SY	13	5300	16	15	15	88	16	39	2.1	Each	1
884516SY	16	8000	19	21	18	103	19	48	3.7	Each	1

No Deration

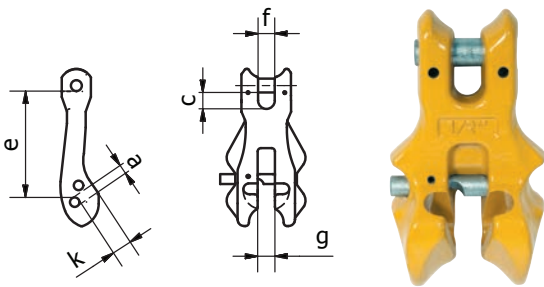

### Grade 80 Clevis Shortening Clutch

Code	Chain Size mm	W.L.L (kg)	c mm	f mm	d mm	g mm	e mm	h mm	a mm	k mm	Approx Weight (kg)	UOM	Pack Qty
884507	7-8	2000	10	9	9	8	50	99	9	12	0.4	Each	1
884510	10	3200	14	12	13	12	74	135	12	25	0.9	Each	1
884513	13	5400	17	17	16	16	82	175	16	30	2.1	Each	1

No Deration

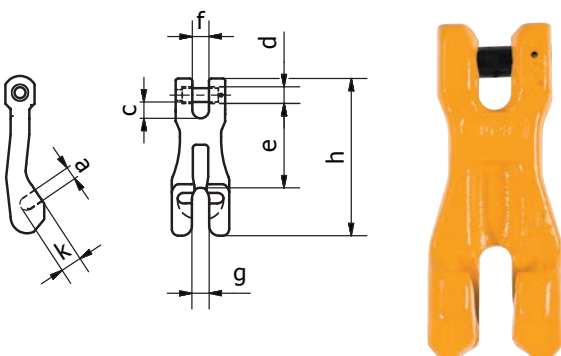

## BEAVER GRADE 80 COMPONENT CONNECTORS (CONT'D)

### Beaver Grade 80 Clevis Shortening Grab Hook

Code	Chain Size mm	W.L.L (kg)	e mm	b mm	d mm	g mm	Approx Weight (kg)	UOM	Pack Qty
886206	6	1100	45	45.7	7.6	8.3	0.25	Each	80
886207	7-8	2000	53.3	50	9	10.5	0.28	Each	55
886210	10	3200	75.5	72	12.5	10.5	0.73	Each	25
886213	13	5300	92	96	16	16.5	1.6	Each	12
886216	16	8000	99	112.5	19.7	19	2.8	Each	8
886220	20	12500	122.7	143	24	24	4	Each	4
886222	22	15000	126	143.5	26	27	72	Each	3

No Deration

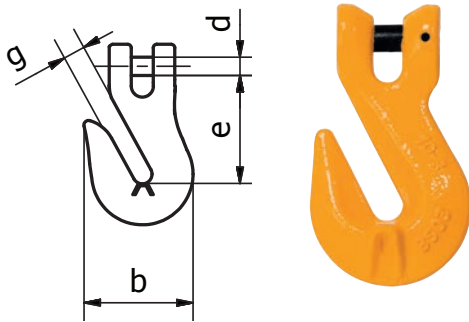

### Beaver Grade 80 Clevis Shortening Grab Hook c/w Safety Pin

Code	Chain Size mm	W.L.L (kg)	e mm	b mm	d mm	g mm	Approx Weight (kg)	UOM	Pack Qty
886213S	13	5300	90	120	16	15	1.75	Each	1
886216S	16	8000	105	130	20	19	2.8	Each	1

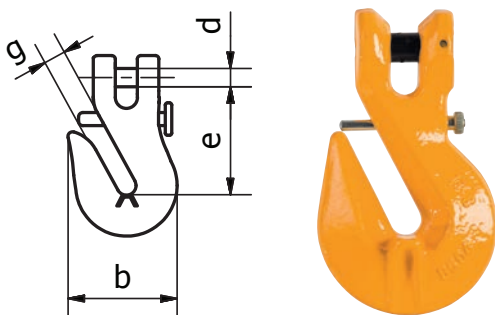



## Beaver Grade 80 Clevis Sling Hook with Safety Latch

Code	Chain Size mm	W.L.L (kg)	e mm	d mm	h mm	b mm	g mm	Approx Weight (kg)	UOM	Pack Qty	Replacement Latch Kit
885106	6	1100	76.4	7.8	20	77.4	24	0.23	Each	50	895106BA
885107	7-8	2000	86	9.3	25	85	27	0.48	Each	30	895107BA
885110	10	3200	104	13	31	103	33.5	0.95	Each	18	895110BA
885113	13	5300	127.8	16.4	42.5	127.5	40	1.85	Each	10	895113BA
885116	16	8000	148	21.3	54	161	51	3.94	Each	5	895116BA
885120	20	12500	179	24.3	58	188	59	6.36	Each	2	895120BA
885122	22	15000	215	26.3	60.4	229	79	10.4	Each	2	895122BA

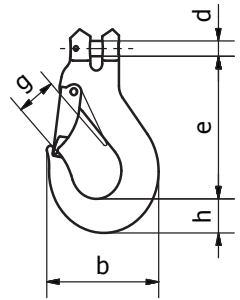

## Beaver Grade 80 Clevis Self Locking Safety Hook

Code	Chain Size mm	W.L.L (kg)	e mm	d mm	h mm	b mm	g mm	Approx Weight (kg)	UOM	Pack Qty	Replacement Trigger Kit
886406Y	6	1100	98	8	22	75	28	0.57	Each	35	896506
886407Y	7-8	2000	120	10	25	86	33	0.91	Each	25	896508
886410Y	10	3200	150	12.5	34	111	45	1.675	Each	12	896510
886413Y	13	5300	185	16	40	136	52	3.33	Each	6	896513
886416Y	16	8000	215	20	53	173	64	6	Each	4	896516
886420Y	20	12500	235	24	64	200	77	8.6	Each	3	896520
886422Y	22	15000	255	28	74	229	92	14.7	Each	1	896522
886426Y	26	21200	316	34	85	256	97	23.5	Each	1	896526

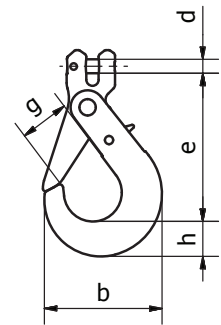

## BEAVER GRADE 80 COMPONENT CONNECTORS (CONT'D)

### Beaver Grade 80 Eye Shortening Grab Hook

Code	Chain Size mm	W.L.L (kg)	e mm	b mm	d1 mm	d2 mm	g mm	Approx Weight (kg)	UOM	Pack Qty
885306	6	1100	51	45.8	13.5	8	8.3	0.14	Each	100
885307	7-8	2000	61.7	51	18	9.5	10.8	0.35	Each	80
885310	10	3200	80	70	20.5	13	13.5	0.65	Each	30
885313	13	5300	99.7	89.7	26	15.5	16.5	1.39	Each	15
885316	16	8000	105.5	113	30.5	19	20	2.1	Each	8
885320	20	12500	140.7	143	37.5	23	25	4	Each	5
885322	22	15000	165	160.5	44	26	28	6.36	Each	3
885326	26	21200	188.5	181.3	44	34	30	9.6	Each	2
885332	32	31500	230	223	57	40	38	19.4	Each	1

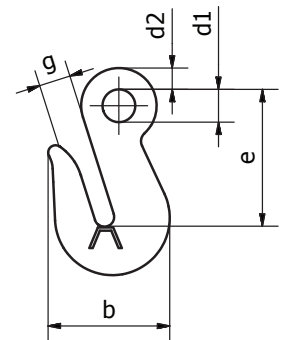

### Beaver Grade 80 Eye Sling Hook with Safety Latch

Code	Chain Size mm	W.L.L (kg)	e mm	b mm	h mm	d1 mm	d2 mm	g mm	Approx Weight (kg)	UOM	Pack Qty	Replacement Latch Kit
885806	6	1100	75	71.3	19	20	10	23.5	0.244	Each	50	895806BA
885807	7-8	2000	111	82	23	23	11	30	0.4	Each	30	895807BA
885810	10	3200	120	109.5	31	38	15	34	0.9	Each	18	895810BA
885813	13	5300	152	146.5	44.5	43	19	39	2.35	Each	10	895813BA
885816	16	8000	184	154	44	50	23	49	3.2	Each	5	895816BA
885820	20	12500	219	198	58.5	62	24	48	5.8	Each	3	895820BA
885822	22	15000	271	259	75.5	62	32	71	8.5	Each	2	895822BA
885826	26	21200	279	262.8	80.5	64	35	81	13	Each	1	895826BA
885832	32	31500	373	355	88	88	37	102	17	Each	1	895832BA

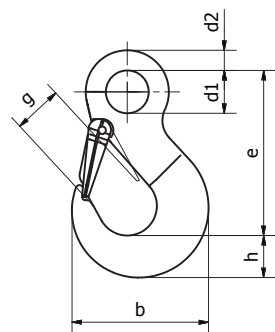



## Beaver Grade 80 Eye Self Locking Safety Hook

Code	Chain Size mm	W.L.L (kg)	e mm	d1 mm	d2 mm	h mm	b mm	g mm	Approx Weight (kg)	UOM	Pack Qty	Replacement Trigger Kit
885706Y	6	1100	107	22	11	22	75	28	0.5	Each	35	896506
885707Y	7-8	2000	133	24	11	25	86	33	0.84	Each	25	896508
885710Y	10	3200	167	32	15.5	34	111	45	1.575	Each	12	896510
885713Y	13	5300	208	39	20.5	40	136	52	3.12	Each	6	896513
885716Y	16	8000	254	49	24.5	53	173	64	5.875	Each	4	896516
885720Y	20	12500	272	59	27.5	64	200	77	8.5	Each	3	896520
885722Y	22	15000	310	70	35	74	229	92	14.3	Each	1	896522
885726Y	26	21200	363	80	34	75	242.8	99	18	Each	1	885726YK
885732Y	32	31500	472	105	45	97	334	147	44.5	Each	1	885732YK

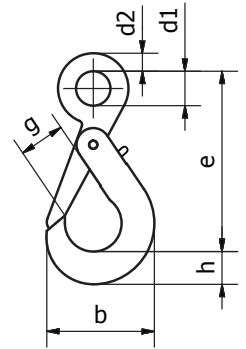

## Beaver Grade 80 Eye Foundry Hook

Code	Chain Size mm	W.L.L (kg)	e mm	d1 mm	d2 mm	h mm	b mm	g mm	Approx Weight (kg)	UOM	Pack Qty
885607	7-8	2000	121.7	18	12	31.2	120.8	63	1.09	Each	12
885610	10	3200	147.5	22	16	36.5	146	76	1.95	Each	8
885613	13	5300	175.6	27	19	44.5	171	89	3.22	Each	5
885616	16	8000	205	32	20	52	198	102	5.26	Each	3
885620	20	12500	232	38	25.4	65	232	114.5	9.07	Each	2
885622	22	15000	263	45	28.7	69	256	127.5	11.79	Each	1

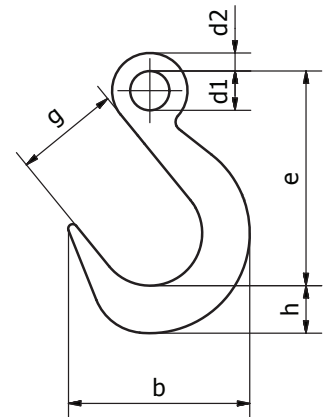

## BEAVER GRADE 80 COMPONENT CONNECTORS (CONT'D)

### Beaver Grade 80 Eye Swivel Self Locking Safety Hook c/w Ball Bearing

*(Swivels under load)*

Code	Chain Size mm	W.L.L (kg)	e mm	d2 mm	h mm	g mm	w mm	Approx Weight (kg)	UOM	Pack Qty	Replacement Trigger Kit
886606	6	1100	163.3	11.5	19	27	32.5	0.71	Each	25	896606
886607	7-8	2000	195	13	26	35	36	1.1	Each	18	896607
886610	10	3200	237	15.5	30	44	42	2	Each	10	896610
886613	13	5300	282	17	27	53	50	4	Each	4	896613
886616	16	8000	341.5	21.5	48	60	61	7.3	Each	2	896616
886620	20	12500	399.5	26.5	61	87	76	11.6	Each	1	896620

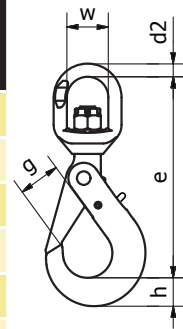

### Beaver Grade 80 Eye Swivel Self Locking Safety Hook

*(Doesn't swivel under load)*

Code	Chain Size mm	W.L.L (kg)	e mm	d2 mm	h mm	g mm	w mm	Approx Weight (kg)	UOM	Pack Qty	Replacement Trigger Kit
886507	7-8	2000	189	14	25	33	34	1.2	Each	15	896508
886510	10	3200	229	16	34	45	42	2.23	Each	8	896510
886513	13	5300	285	22	40	52	52	4.27	Each	6	896513
886516	16	8000	335	23	53	67	60	7.75	Each	3	896516
886520	20	12500	375	27	64	77	74	11.9	Each	2	896520

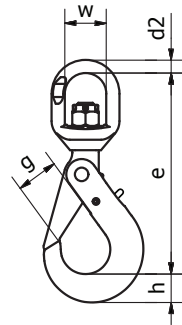

### Grade 80 Eye Swivel Hook with Safety Latch

Code	Chain Size mm	W.L.L (kg)	e mm	d2 mm	h mm	g mm	w mm	Approx Weight (kg)	UOM	Pack Qty	Replacement Latch Kit
885407	7-8	2000	164	14	28	25	34	0.93	Each	15	895407
885410	10	3200	187	16	36	29	42	1.75	Each	8	895410
885413	13	5300	245	20	45	40	52	3.4	Each	7	895413
885416	16	8000	286	23	48	47	60	6.025	Each	4	895416

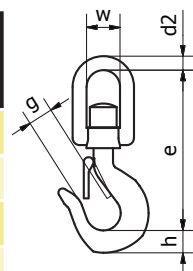

## Beaver Grade 80 Eye Container Hook

Code	Dsc.	W.L.L (kg)	A mm	R mm	D mm	H mm	F mm	E mm	L mm	Approx Weight (kg)	UOM	Pack Qty
886845L	Left 45°	12500	46	60	70	25	75	48	240	4	Each	2
886845R	Right 45°	12500	46	60	70	25	75	48	240	4	Each	2

Approved for container lifting as part of an assembly

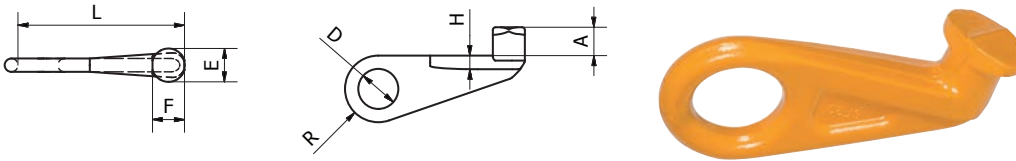

## Beaver Grade 80 Clevis Choker Hook

Code	Chain Size mm	W.L.L (kg)	a mm	b mm	c mm	d mm	e mm	f mm	g mm	h mm	d2 mm	w mm	Approx Weight (kg)	UOM	Pack Qty
888807	7-8	2000	35.5	73	12.5	9.2	59.5	9.5	9.8	95.5	20	18	0.4	Each	40
888810	10	3200	45	98	16	12	80.5	13	13	137	24	22	0.9	Each	20
888813	13	5300	53.5	119	14	16	95	16	16	165	30	30	1.75	Each	10

No Deration

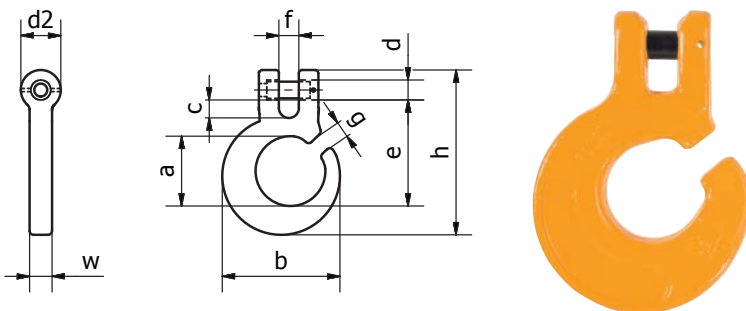



## BEAVER GRADE 80 COMPONENT CONNECTORS (CONT'D)

### Beaver Grade 80 Weld-on Safety Excavator Hook

Code	W.L.L (kg)	b mm	g mm	L1 mm	L2 mm	w mm	Approx Weight (kg)	UOM	Pack Qty	Replacement Latch Kit
886701A	1000	53	18	87	55	20	0.35	Each	30	896701
886703A	3000	106	30.5	129	86	36	1.2	Each	15	896703
886705A	5000	133	34	171	118.5	43.5	2.46	Each	8	896705
886708	8000	136.5	34	177	118.5	51	3.26	Each	6	896708
886710	10000	169.5	51	223	154	53	5.17	Each	4	896710

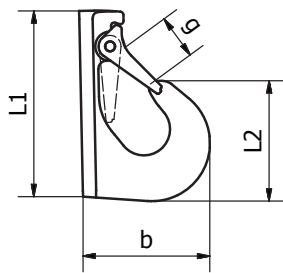

## BEAVER GRADE M COMPONENT CONNECTOR

### Beaver Grade M General Purpose Alloy Swivel Hook with Latch

Code	W.L.L (kg)	a mm	d1 mm	e mm	g mm	w mm	Approx Weight (kg)	UOM	Pack Qty
263920	2000	53	18	87	55	20	1.33	Each	30

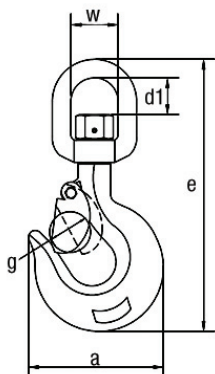



**GRADE 100 LIFTING CHAIN AND COMPONENTS**

## BEAVER GRADE 100 LIFTING CHAIN AND COMPONENTS

### Beaver Grade 100 Lifting Chain

Beaver Grade 100 Lifting Chain is sourced from world leading manufacturers in Europe.

Our Grade 100 chain complies with European Standard EN 818-2 and is tested in accordance with Australian Standard AS 2321.

- Its rugged, versatile, high strength and low-weight
- Beaver-Grade 100 Chain carries the mark "10" stamped on every link along its entire length for easy identification
- Sizes available from 6-32mm

### Beaver Grade 100 Lifting Components

Beaver Grade 100 Lifting Components are sourced from world leading manufacturers in Europe.

Our Grade 100 components comply with European Standard EN 1677 and are tested in accordance with Australian Standard AS 2321.

- Beaver-Grade 100 easy identification – please see drawing 2.1
  - Sizes available 6mm-32mm

### Drawing 2.1 Grade 100 Component markings

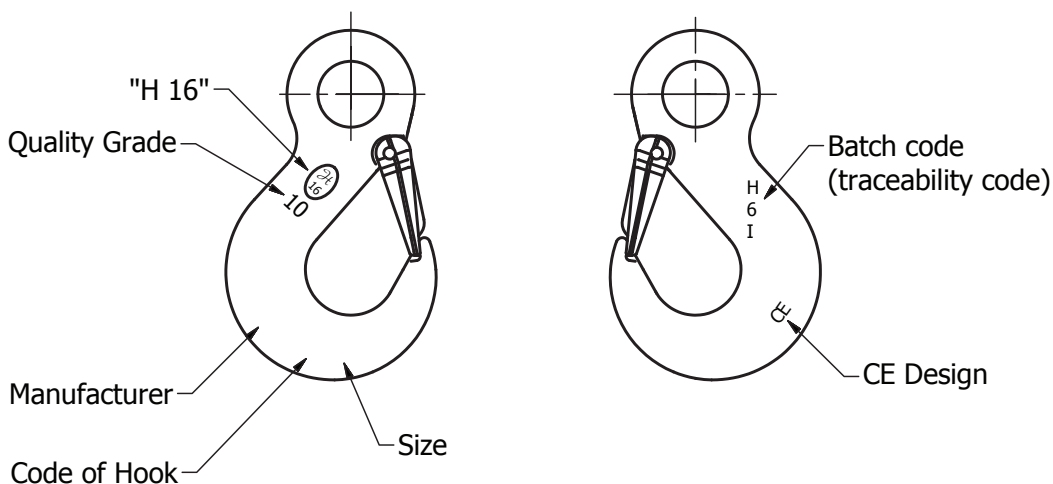





## BEAVER GRADE 100 – SINGLE AND DOUBLE LEG CHAIN SLINGS

### Beaver Grade 100 Single Leg Sling with Clevis Sling Hook

*c/w Safety Latch & Shortening Grab Hook– AS 3775.1*

Code	Chain Size mm	Effective Length mtr	W.L.L No Deration (kg)
G1-CSA08117525	8	1	2500
G1-CSA08127525	8	2	2500
G1-CSA08137525	8	3	2500
G1-CSA10117525	10	1	4000
G1-CSA10127525	10	2	4000
G1-CSA10137525	10	3	4000



### Beaver Grade 100 Double Leg Sling with Clevis Sling Hook

*c/w Safety Latch & 2 Shortening Grab Hook– AS 3775.1*

Code	Chain Size mm	Effective Length mtr	W.L.L @ 60° No Deration (kg)
G1-CSA08217525	8	1	4300
G1-CSA08227525	8	2	4300
G1-CSA08237525	8	3	4300
G1-CSA08247525	8	4	4300
G1-CSA08267525	8	6	4300
G1-CSA10217525	10	1	6900
G1-CSA10227525	10	2	6900
G1-CSA10237525	10	3	6900
G1-CSA10247525	10	4	6900
G1-CSA10267525	10	6	6900
G1-CSA13217525	13	1	11600
G1-CSA13227525	13	2	11600
G1-CSA13237525	13	3	11600
G1-CSA13247525	13	4	11600





## Beaver Grade 100 Single Leg Sling with Clevis Self Locking Hook

*c/w Shortening Grab Hook – AS 3775.1*

Code	Chain Size mm	Effective Length mtr	W.L.L No Deration (kg)
G1-CSA08117545	8	1	2500
G1-CSA08127545	8	2	2500
G1-CSA08137545	8	3	2500
G1-CSA10117545	10	1	4000
G1-CSA10127545	10	2	4000
G1-CSA10137545	10	3	4000



## Beaver Grade 100 Double Leg Sling with Clevis Self Locking Hook

*c/w 2 Shortening Grab Hook – AS 3775.1*

Code	Chain Size mm	Effective Length mtr	W.L.L @ 60° No Deration (kg)
G1-CSA08217545	8	1	4300
G1-CSA08227545	8	2	4300
G1-CSA08237545	8	3	4300
G1-CSA08247545	8	4	4300
G1-CSA08267545	8	6	4300
G1-CSA10217545	10	1	6900
G1-CSA10227545	10	2	6900
G1-CSA10237545	10	3	6900
G1-CSA10247545	10	4	6900
G1-CSA10267545	10	6	6900
G1-CSA13217545	13	1	11600
G1-CSA13227545	13	2	11600
G1-CSA13237545	13	3	11600
G1-CSA13247545	13	4	11600





## MASTER LINKS AND SETS FOR G100 ASSEMBLY SYSTEMS

### Beaver – Lifting Chain – Grade 100 AS 2321

Code	W.L.L (kg)	Size mm	S mm	R Pitch mm	F Outside Width mm	Weight kg/m	Finish	UOM	Metres Per 100kg	Metres Per 500kg Drum
WIN6	1400	6	6	18	21.6	0.96	Painted	Metre	104	520
WIN8	2500	8	8	24	28.8	1.57	Painted	Metre	64	320
WIN10	4000	10	10	30	36.0	2.46	Painted	Metre	40	200
WIN13	6700	13	13	39	46.8	4.18	Painted	Metre	24	120
WIN16	10000	16	16	48	57.6	6.28	Painted	Metre	15.9	79.5
WIN20	16000	20	20	62	70.5	8.90	Painted	Metre	11.2	56
WIN22	19000	22	22	66	79.2	11.88	Painted	Metre	8.2	41
WIN26	26500	26	26	78	94.1	16.18	Painted	Metre	6.18	30.9
WIN32	40000	32	32	96	107.0	24.10	Painted	Metre	4.15	20.75

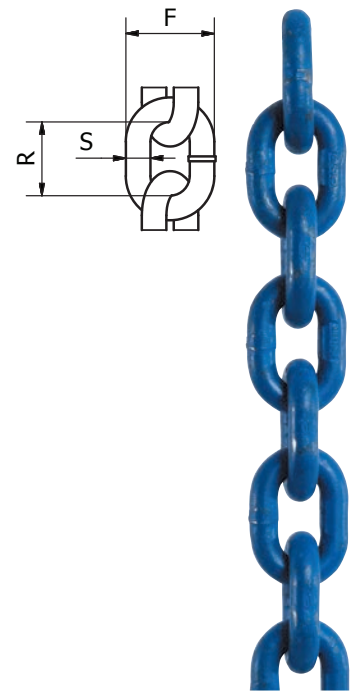

*Designed for Single, 2, 3 & 4 Leg Applications*

### Beaver – Large Master Link – Grade 100

Code	Chain Size mm		W.L.L (kg)	S mm	R mm	F mm	T mm	Approx Weight (kg)	UOM	Pack Qty
	1 Leg	2 Leg								
MW10	5	5	1730	11	90	65	10	0.22	Each	25
MW13	6.7	7	2400	14	120	70	10	0.44	Each	16
MW16	8	7	3300	16	140	80	13	0.67	Each	8
MW18	10	8	4300	19	160	95	14	1.09	Each	6
MW22	13	10	6900	23	160	110	17	1.69	Each	3
MW26	16	13	11600	27	190	110	20	2.65	Each	2
MW32	20	16	17300	33	230	130	26	4.78	Each	1
MW36	22	20	27700	38	275	150	29	7.48	Each	1
MW56	32	26	45800	56	350	250	-	21.98	Each	1

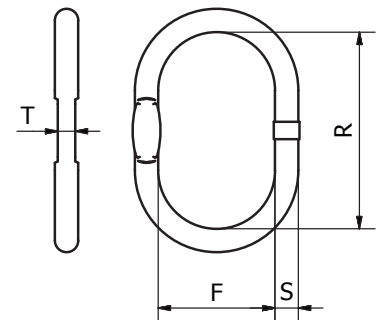

*Designed for Single & 2 Leg Applications*

## Beaver – AW Master Link – Grade 100

Code	Chain Size mm		W.L.L (kg)	S mm	R mm	F mm	T mm	Approx Weight (kg)	UOM	Pack Qty
	1 Leg	2 Leg								
AW16	8	7	3500	16	110	60	14	0.53	Each	1
AW18	10	8	5000	19	135	75	14	0.92	Each	1
AW22	13	10	7600	23	160	90	17	1.6	Each	1
AW26	16	13	10000	27	180	100	20	2.46	Each	1
AW32	19	16	14000	33	200	110	26	4.14	Each	1
AW36	22	19	25100	36	260	140	-	6.22	Each	1
AW45	26	22	30800	45	340	180	-	12.82	Each	1
AW50	32	26	40000	50	350	190	-	16.55	Each	1
AW56	-	32	64000	60	400	200	-	27.01	Each	1
AW72	-	-	85000	70	460	250	-	45	Each	1

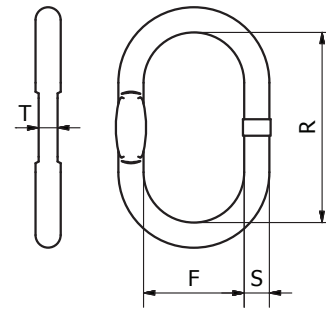

Designed for Single & 2 Leg Applications

## Beaver – Large Master Link – Grade 100

for use with large Ram horn hooks. c/w Intermediate Rings for chain slings. Grade 100

Code	Chain Size mm	W.L.L (kg)	S mm	E mm	R mm	F mm	T mm	s mm	r mm	f mm	t mm	Approx Weight (kg)	UOM	Pack Qty
VLW2-8	8	5600	27	410	340	180	20	13	54	25	10	5.1	Each	1
VLW2-10	10	9500	33	425	340	180	27	17	70	34	14	8	Each	1
VLW2-13	13	14000	40	455	340	180	29	20	85	40	-	12.3	Each	1
VLW2-16	16	21200	40	480	340	180	29	23	115	50	17	13.8	Each	1

Designed for 2, 3 & 4 Leg Applications

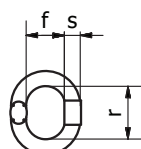
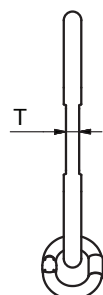
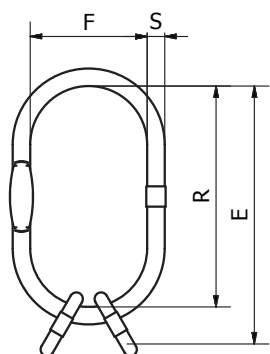

## MASTER LINKS AND SETS FOR G100 ASSEMBLY SYSTEMS CONT'D

### Beaver – VW Multi-Leg Master Link Assembly – Grade 100

Code	Chain Size mm	W.L.L @60° (kg)	S mm	E mm	R mm	F mm	T mm	s mm	r mm	f mm	t mm	Approx Weight (kg)	UOM	Pack Qty
VW7-8	7-8	7600	23	230	160	90	17	17	70	34	14	2.32	Each	1
VW10	10	9600	27	265	180	100	20	20	85	40	14	3.68	Each	1
VW13	13	14000	33	315	200	110	26	23	115	50	17	6.46	Each	1
VW16	16	21200	36	400	260	140	-	27	140	65	20	10.06	Each	1
VW20	20	34100	50	500	350	190	-	33	150	70	26	22.87	Each	1
VW22	22	40000	50	520	350	190	-	36	170	75	-	24.79	Each	1
VW26	26	56000	60	570	400	200	-	45	170	80	-	41.31	Each	1
VW32	32	85	70	660	460	250	-	50	200	100	-	66.6	Each	1

*Designed for 2, 3 & 4 Leg Applications*

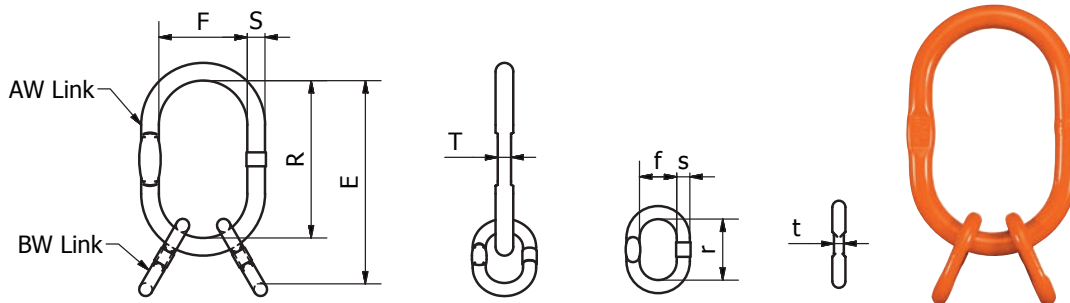



## Beaver – VMW Enlarged Multi-Leg Master Link Assembly – Grade 100

Code	Chain Size mm	W.L.L @60° (kg)	S mm	E mm	R mm	F mm	T mm	s mm	r mm	f mm	t mm	Approx Weight (kg)	UOM	Pack Qty
VMW7-8	8	6600	23	230	160	110	17	17	70	34	14	2.41	Each	1
VMW10	10	10100	27	275	190	110	20	20	85	40	14	4.01	Each	1
VMW13	13	15700	33	345	230	130	26	23	115	50	17	6.9	Each	1
VMW16	16	21200	38	415	275	150	29	27	140	65	20	11.12	Each	1
VMW20	20	34100	56	500	350	250	-	33	150	70	26	28.08	Each	1
VMW22	22	40000	56	520	350	250	-	36	170	75	-	30.62	Each	1

Designed for 2, 3 & 4 Leg Applications

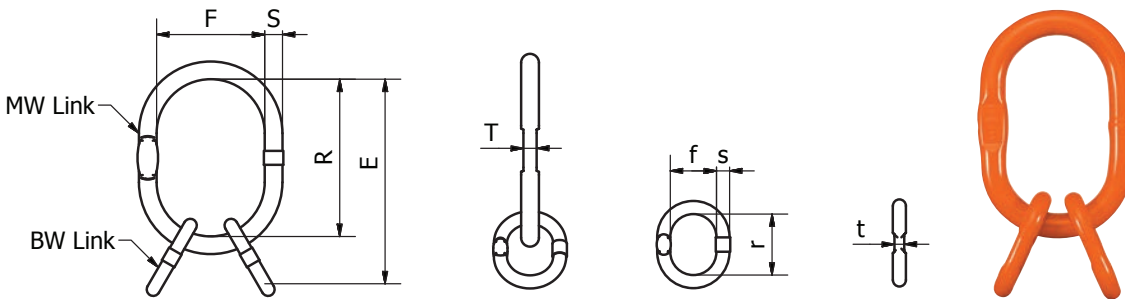

## Beaver – Connecting Link – Grade 100

Code	Chain Size mm	W.L.L (kg)	e mm	c mm	s mm	d mm	b mm	g mm	Approx Weight (kg)	UOM	Pack Qty	Replacement Bolt Kit
CW6	6	1400	44	8	11	8	39	14	0.06	Each	20	CBHW6
CW8	8	2500	62	12	15	10	53	18	0.18	Each	20	CBHW8
CW10	10	4000	72	13	18	13	63	23	0.33	Each	30	CBHW10
CW13	13	6700	88	19	22	17	79	28	0.7	Each	20	CBHW13
CW16	16	10000	103	21	29	21	106	33	1.4	Each	12	CBHW16
CW20	20	16000	115	30	35	25	118	42	2.14	Each	8	CBHW20
CW22	22	19000	161	34	39	25	148	51	4.15	Each	6	CBHW22
CW26	26	26500	190	40	46	30	175	60	6.7	Each	4	CBHW26
CW32	32	40000	206	47	56	35	216	80	11.2	Each	2	CBHW32

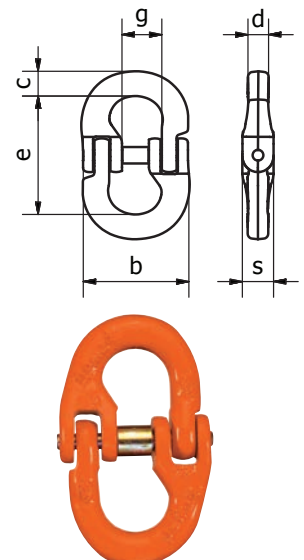

## MASTER LINKS AND SETS FOR G100 ASSEMBLY SYSTEMS (CONT'D)

### Beaver – Clevis Grab Hook – Grade 100

Code	Chain Size mm	W.L.L (kg)	e mm	b mm	d mm	g mm	Approx Weight (kg)	UOM	Pack Qty
KPW6	6	1400	45	47	7	8	0.19	Each	80
KPW8	8	2500	61	58	10	11.5	0.38	Each	55
KPW10	10	4000	76	76	13	13	0.85	Each	25
KPW13	13	6700	104	101	16	17	1.9	Each	12
KPW16	16	10000	116	120	20	20	3.6	Each	8
KPW20	20	16000	141	150	24	25	6.15	Each	4
KPW22	22	19000	158	165	27	27	9	Each	3

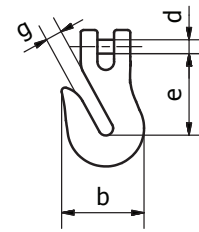

No Deration



### CAUTION

The design of the clevis shortening grab hooks allow for a quick visual check that the chain is seated in the hook's mouth correctly. The design of the hook means that the supported chain no longer contacts the bearing surface of the hook, due to the chain being supported by the side faces of the hook. Meaning no deration of the rated capacity.

## Beaver – Clevis Sling Hook c/w Safety Catch – Grade 100

Code	Chain Size mm	W.L.L (kg)	e mm	h mm	d mm	g mm	b mm	Approx Weight (kg)	UOM	Pack Qty	Replacement Latch Kit
KHSW6	6	1400	69	20	7	19	66	0.2	Each	50	SFGW5/6
KHSW8	8	2500	95	28	10	26	90	0.6	Each	30	SFGW7/8
KHSW10	10	4000	109	35	13	31	108	1.1	Each	18	SFGW10
KHSW13	13	6700	136	41	16	39	131	2	Each	10	SFGW13
KHSW16	16	10000	155	49	20	45	153	3.48	Each	5	SFGW16
KHSW20	20	16000	184	53	24	53	177	5	Each	2	SFGW20
KHSW22	22	19000	214	62	27	62	196	9	Each	2	SFGW22

No Deration

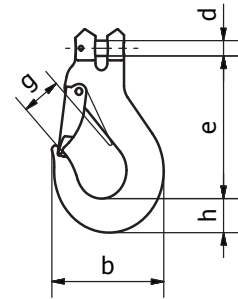

## Beaver – Clevis Self Locking Hook – Grade 100

Code	Chain Size mm	W.L.L (kg)	e mm	h mm	b mm	d mm	g mm	Approx Weight (kg)	UOM	Pack Qty	Replacement Trigger Kit
KLHW8	8	2500	123	26	88	10	34	0.9	Each	25	VLHW7/8
KLHW10	10	4000	144	30	107	13	45	1.6	Each	12	VLHW10
KLHW13	13	6700	180	40	138	16	52	2.9	Each	6	VLHW13
KLHW16	16	10000	218	50	168	20	60	5.8	Each	4	VLHW16
KLHW19-20	20	16000	260	62	194	24	70	10	Each	3	VLHW20/22
KLHW22	22	19000	284	65	211	27	81	12.8	Each	1	VLHW20/22
KLHW26	26	26500	339	79	253	33	100	21	Each	1	VLHW26

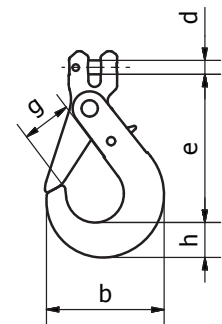

## MASTER LINKS AND SETS FOR G100 ASSEMBLY SYSTEMS (CONT'D)

### Beaver – Eye Shortening Grab Hook – Grade 100

Code	Chain Size mm	W.L.L (kg)	e mm	b mm	d1 mm	d2 mm	g mm	Approx Weight (kg)	UOM	Pack Qty
PW8	7-8	2500	71	58	20	12	11	0.4	Each	80
PW10	10	4000	88	76	22	15	13	0.9	Each	30
PW13	13	6700	113	101	26	18	17	1.8	Each	15
PW16	16	10000	129	118	32	23	19	3.6	Each	8
PW20	20	16000	151	150	36	27	25	6.15	Each	5
PW22	22	19000	170	165	42	31	27	8.3	Each	3
PW26	26	26500	201	195	50	37	32	13.8	Each	2
PW32	32	31500	240	210	60	40	39	18.6	Each	1

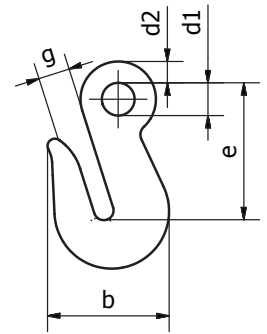

Used for the shortening of chain sling legs. It's the first grab hook in Grade 100 on the market. Due to its unique design there is no deration in the load capacity. This is due to the 4 fold feature of the hooks supporting cradle design.

*No Deration*

### Beaver – Eye Grab Hook c/w Safety Pin – Grade 100

Code	Chain Size mm	W.L.L (kg)	e mm	b mm	d1 mm	d2 mm	g mm	Approx Weight (kg)	UOM	Pack Qty	Replacement Pin Kit
PSW7-8	8	2500	71	58	20	12	11	0.4	Each	1	PSGW7/8
PSW10	10	4000	88	76	22	15	13	0.9	Each	1	PSGW10
PSW13	13	6700	113	101	26	18	17	1.8	Each	1	PSGW13
PSW16	16	10000	129	118	32	23	19	3.6	Each	1	PSGW16

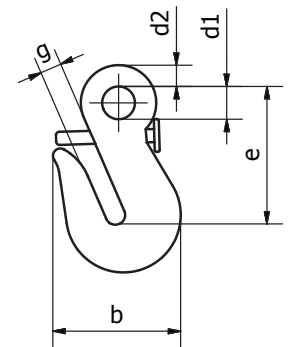

The first grade 100 eye shortening safety grab hook which prevents the accidental release of the chain whilst still providing no deration in capacity. This feature is useful when the chains have been loaded fully as there is no possibility of the chain becoming dislodged from the grab hook. Meaning once you have adjusted the legs there is no need to adjust them again.

*No Deration*



## Beaver – Safety Eye Self Locking Hook – Grade 100

Code	Chain Size mm	W.L.L (kg)	e mm	h mm	b mm	d1 mm	d2 mm	g mm	Approx Weight (kg)	UOM	Pack Qty	Replacement Trigger Kit
LHW7-8	7-8	2500	136	26	88	25	12	34	0.9	Each	25	VLHW7/8
LHW10	10	4000	169	30	107	35	15	45	1.5	Each	12	VLHW10
LHW13	13	6700	205	40	138	40	20	52	2.7	Each	8	VLHW13
LHW16	16	10000	251	50	168	50	27	60	5.7	Each	4	VLHW16
LHW19-20	20	16000	290	62	194	60	30	70	9.8	Each	3	VLHW19-20
LHW22	22	19000	322	65	211	70	32	81	12.4	Each	1	VLHW22

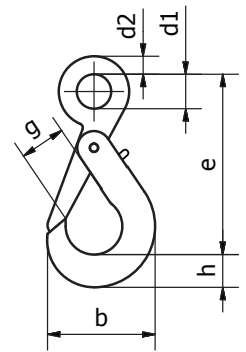

## Beaver – Eye Sling Hook c/w Safety Catch – Grade 100

Code	Chain Size mm	W.L.L (kg)	e mm	h mm	d1 mm	d2 mm	g mm	b mm	Approx Weight (kg)	UOM	Pack Qty	Replacement Latch Kit
HSW8	7-8	2500	106	27	25	11	26	88	0.5	Each	30	SFGW7/8
HSW10	10	4000	131	33	34	16	31	109	1.1	Each	18	SFGW10
HSW13	13	6700	164	44	43	19	39	134	2.2	Each	10	SFGW13
HSW16	16	10000	183	50	50	25	45	155	3.5	Each	5	SFGW16
HSW20	20	16000	205	55	55	27	53	178	5.8	Each	3	SFGW20
HSW22	22	19000	225	62	60	29	62	196	8	Each	2	SFGW22
HSW26	26	26500	259	75	70	37	73	235	12.8	Each	1	SFGW26-32
HSW32	32	31500	299	89	66	42	87	281	22.4	Each	1	SFGW26-32

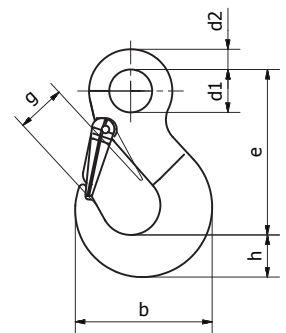

## MASTER LINKS AND SETS FOR G100 ASSEMBLY SYSTEMS (CONT'D)

### Beaver – Eye Foundry Hook – Grade 100

Code	Chain Size mm	W.L.L (kg)	e mm	h mm	d1 mm	d2 mm	g mm	b mm	Approx Weight (kg)	UOM	Pack Qty
FW10	10	4000	158	35	31	14	76	143	1.77	Each	8
FW13	13	6700	190	42	39	17	89	170	2.82	Each	5
FW16	16	10000	224	50	47	22	102	200	5.03	Each	3
FW20	20	16000	260	61	56	28	114	231	7.6	Each	2

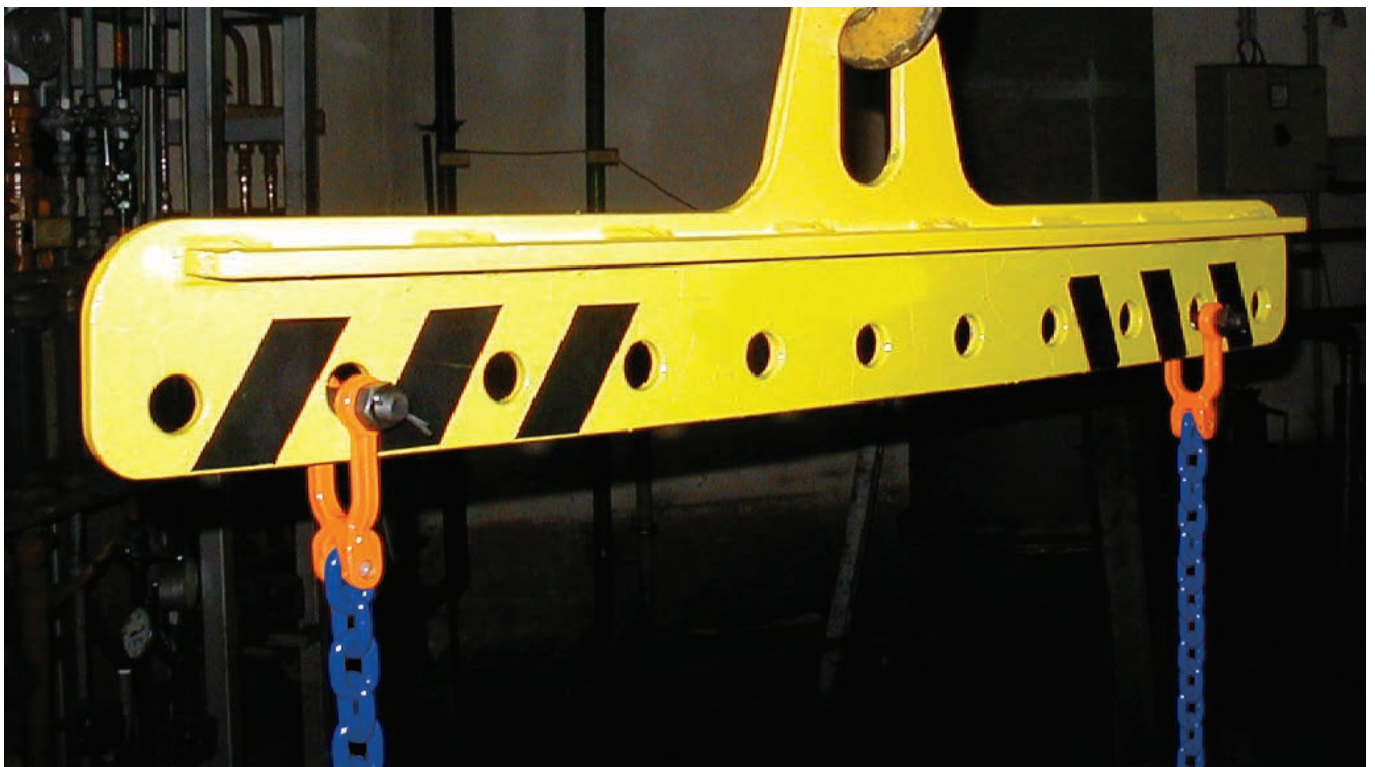
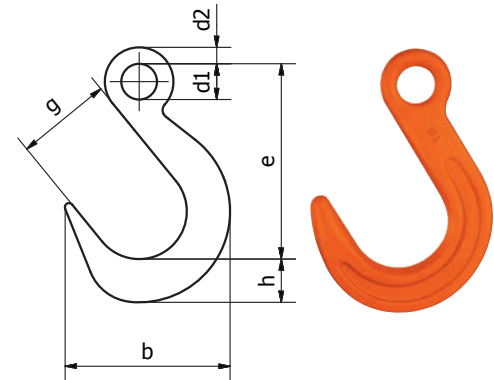

## B-ALLOY-V WELD-ON LIFTING AND LASHING RINGS

### B-Alloy-V Weld-on Lifting and Lashing Rings – Design Safety Factor 4:1

Code	W.L.L Tonnes (kg)	A mm	B mm	C mm	D mm	E mm	F mm	G mm	I mm	M mm	Weld mm HV+aL	Weight (kg)
BALPV015	1500	38	79	66	14	13.5	32	25	31	2	HV5+3	0.40
BALPV025	2500	45	92.5	77	16	13.5	36	27	38	3.5	HV7+3	0.60
BALPV040	4000	51	102	87	18	16.5	42	32	40.5	2	HV8+3	0.90
BALPV067	6700	67	138	115	24	22.5	61	44	55	4	HV12+4	2.0
BALPV100	10000	67.5	142	129	26.5	57.5	75	53	57.5	4	HV16+4	3.0
BALPV160	16000	100	215	190	40	26	95	69	85	5	HV25+6	6.9

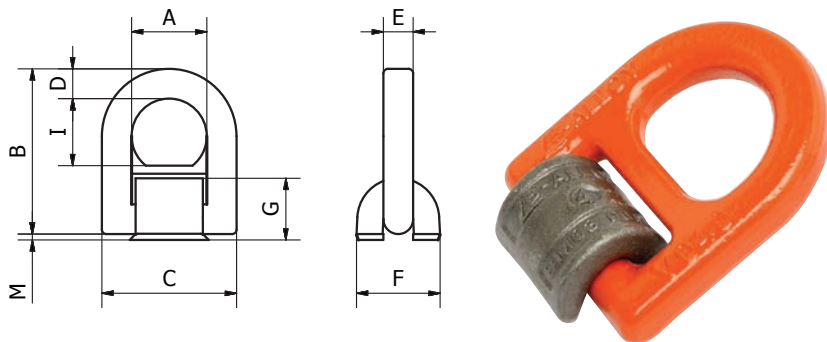

### Welding Instructions & Procedures

The welding should only be carried out according to EN 287 or AWS Standards by an authorised welder.

Beaver Code	WLL Tonnes	Weld Size	Weld Length	Weld Volume
BALPV015	1.5	HV 5+a3 $\nabla$	2 x 33mm	ca. 1,2cm <sup>3</sup>
BALPV025	2.5	HV 7+a3 $\nabla$	2 x 40mm	ca. 2,6cm <sup>3</sup>
BALPV040	4	HV 8+a3 $\nabla$	2 x 40mm	ca. 3,2cm <sup>3</sup>
BALPV067	6.7	HV 12+a4 $\nabla$	2 x 60mm	ca. 8.7cm <sup>3</sup>
BALPV100	10	HV 16+a4 $\nabla$	2 x 60mm	ca. 15,5cm <sup>3</sup>
BALPV160	16	HV 25+a6 $\nabla$	2 x 90mm	ca. 56cm <sup>3</sup>

Detailed welding instructions are available on request.

## B-ALLOY-V BOLT-ON LIFTING AND LASHING LUG

### B-Alloy-V Bolt-on Lifting and Lashing Lug – Design Safety Factor 4:1

Code	W.L.L Tonnes	M Thread Size mm	Torque N*M	L mm	A mm	B mm	C mm	D mm	E mm	H mm	G mm	P mm	Q mm	X mm	Y mm	Z mm	Weight (kg)
BRLP-M12	1	M12	100	33	35.6	11.2	60	35.3	33.5	80.5	60.5	15.6	31.2	8.03	5	25.4	0.4
BRLP- 1/2UNC	1	1/2UNC	100	33	35.6	11.2	60.3	5.3	33.5	80.5	60.5	15.6	31.2	8.03	5	25.4	0.4
BRLP-M16	1.5	M16	150	33	35.6	11.2	60	35.3	33.5	80.5	60.5	15.6	31.2	8.03	5	25.4	0.4
BRLP-M20	2.5	M20	300	33	61	19.1	82.6	60.2	57.2	137	103	26.7	53.3	15.9	9.4	44.5	1.8
BRLP-M24	4	M24	400	37	61	19.1	82.6	60.2	57.2	137	103	26.7	53.3	15	9.4	44.5	1.8
BRLP-M30	6	M30	500	50	81.3	25.4	110.8	80.3	76.2	183	137.2	35.6	71.1	22.1	15	60.3	4.1
BRLP-M36	8	M36	800	54	81.3	25.4	110.8	80.3	76.2	183	137.2	35.6	71.1	22.1	15	60.3	4.1
BRLP-M42	10	M42	1000	63	101.6	31.8	139.4	100.3	95.3	229	171.5	44.5	88.9	27.1	18	76.2	9

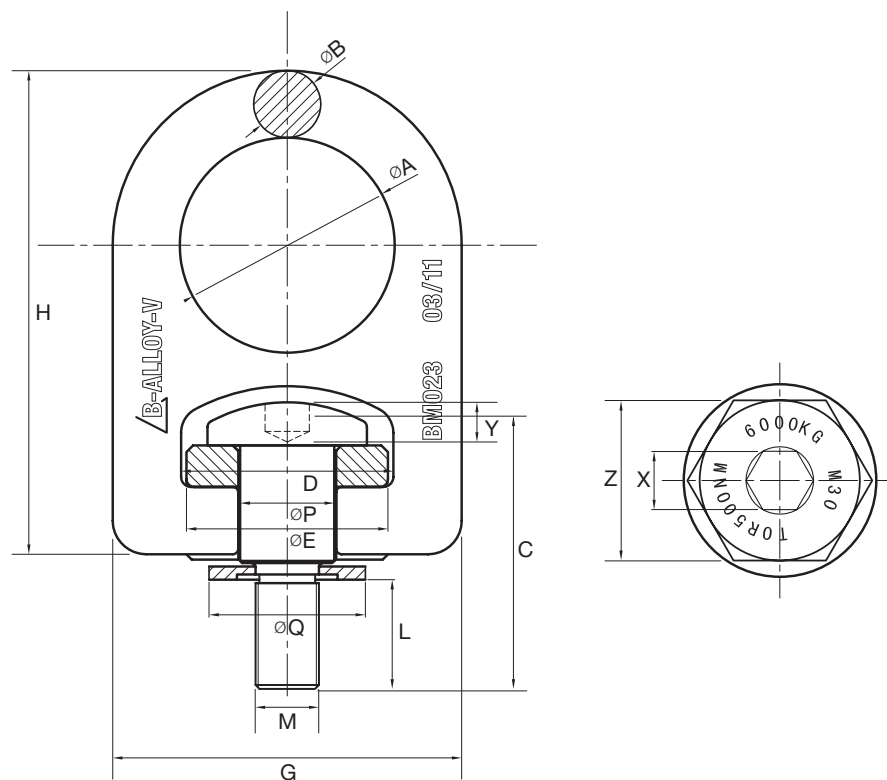



## FEATURES

- High strength lifting or lashing point
- Has full working load limit at all angles & rotations
- Easily attached to the required lifting base or item
- Design Safety Factor 4:1
- All B-Alloy-V Bolt-On Lugs are 100% magnetically crack inspected (MCI)
- Eye screw in electro galvanised finish
- Durable powder coated finish of the lifting lug
- Functional compact design
- Lifting lug with raised markings indicating Month & Year of manufacture, W.L.L. & B-Alloy-V ID & test number for accurate traceability.
- Eye screw with raised markings showing W.L.L, size of thread & torque required when tightening
- Test Certificate available
- Several sizes available with UNC threads
- Batch tested using Beaver's NATA accredited laboratories & state of the art technology

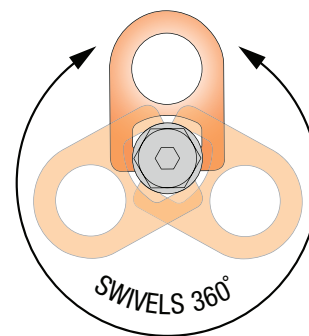
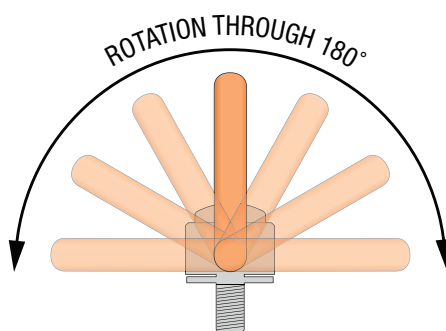



**GRADE 50 LIFTING CHAIN AND COMPONENTS**

## BEAVER-GRADE 50 STAINLESS STEEL LIFTING CHAIN AND COMPONENTS

### Beaver-Grade 50 Stainless Steel Lifting Chain

Beaver-Grade 50 Stainless Steel Lifting Chain is manufactured from Grade 316 stainless steel and is tested in accordance with Australian Standard AS 4797. It's high corrosive properties make it ideal for lifting in environments such as water treatment plants, waste management and food processing.

- Beaver-Grade 50 Chain carries the mark "PWG5", stamped on every link along its entire length for easy identification

### Beaver-Grade 50 Stainless Steel Lifting Components

Beaver-Grade 50 Stainless Steel Lifting Components are also manufactured from Grade 316 stainless steel and is tested in accordance with Australian Standard AS 4797. It is ideal for lifting in environments such as water treatment plants, waste management and food processing.

- Beaver-Grade components – see image 4.1

**Image 4.1 Grade 50 Component markings**

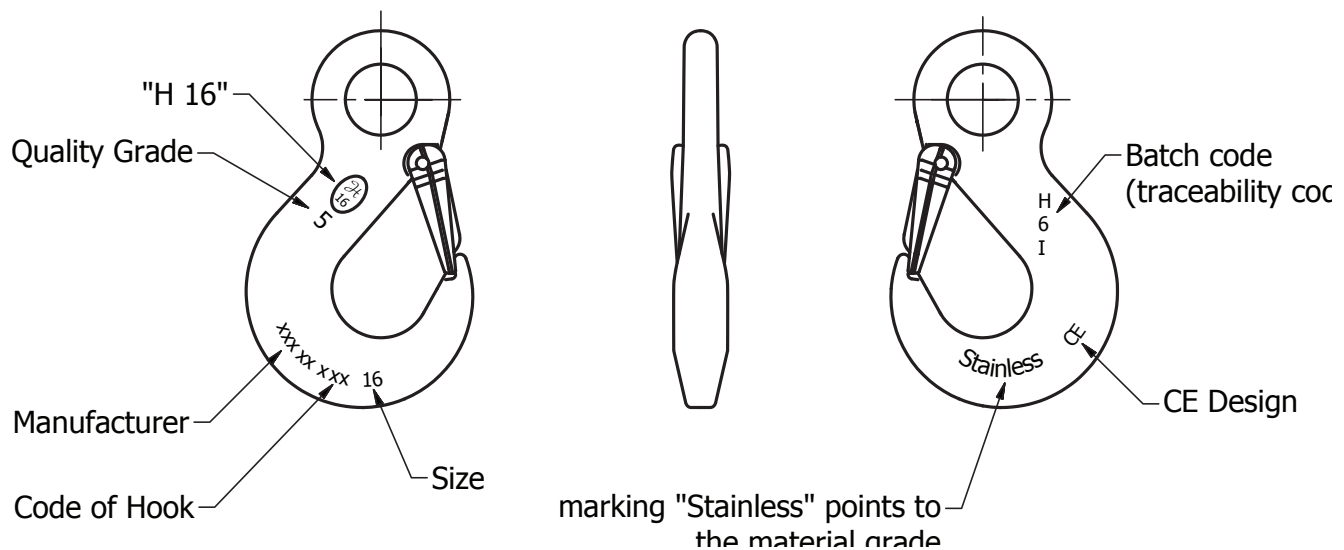

## BEAVER GRADE 50 STAINLESS STEEL - SINGLE AND DOUBLE LEG CHAIN SLINGS

### Beaver Grade 50 Single Leg Sling with Eye Sling Hook

*c/w Safety Latch & Shortening Grab Hook*

Code	Chain Size mm	Effective Length mtr	W.L.L No Deration (Kg)
G5-CSA07117535	7	1	1000
G5-CSA07127535	7	2	1000
G5-CSA07137535	7	3	1000
G5-CSA10117535	10	1	2000
G5-CSA10127535	10	2	2000
G5-CSA10137535	10	3	2000



### Beaver Grade 50 Double Leg Sling with Eye Sling Hook

*c/w Safety Latch & Shortening Grab Hook*

Code	Chain Size mm	Effective Length mtr	W.L.L @ 60° No Deration (Kg)
G5-CSA07217535	7	1	1700
G5-CSA07227535	7	2	1700
G5-CSA07237535	7	3	1700
G5-CSA10217535	10	1	3400
G5-CSA10227535	10	2	3400
G5-CSA10237535	10	3	3400
G5-CSA10247535	10	4	3400
G5-CSA10267535	10	6	3400
G5-CSA13217535	13	1	5440
G5-CSA13227535	13	2	5440
G5-CSA13237535	13	3	5440
G5-CSA13247535	13	4	5440





## BEAVER GRADE 50 CHAIN AND COMPONENTS

### Beaver Grade 50 Stainless Steel Lifting Chain G316

Safety Factor 4:1 to AS 4797

Code	W.L.L (kg)	Size mm	S mm	R mm	F mm	Finish	Weight kg/m	UOM	Metres per 100 kg
WOX5	500	5	5	16	17.5	Stainless Steel	0.56	Metre	178
WOX7	1000	7	7	21	23.53	Stainless Steel	1.1	Metre	90
WOX10	2000	10	10	30	33.5	Stainless Steel	2.2	Metre	45
WOX13	3200	13	13	39	43.5	Stainless Steel	3.8	Metre	26

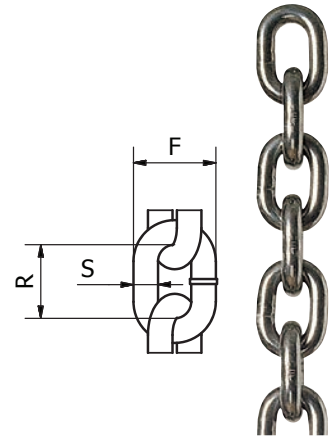

### Beaver Stainless Steel Master Link Grade 50 G316

Code	Chain Size mm		W.L.L (kg)	S mm	R mm	F mm	T mm	Approx Weight (kg)	UOM	Pack Qty
	1 Leg	2 Leg								
AWI10	5	5	700	10	80	50	-	0.14	Each	20
AWI13	7	-	1050	13	110	60	10	0.34	Each	20
AWI16	-	7	1400	16.5	110	60	14	0.53	Each	20
AWI18	10	-	2000	18.5	135	75	14	0.92	Each	20
AWI22	13	10	3200	23	160	90	17	1.6	Each	5
AWI26	16	13	5000	27	180	100	20	2.46	Each	5

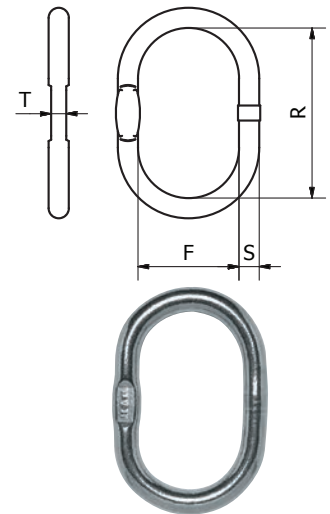

### Beaver Stainless Steel Grade 50 VLWI Shortener

Code	W.L.L (kg)	e mm	a mm	d mm	d1 mm	g mm	Weight kg
VLWI 5/6	750	80	52	16	26	8	0.18
VLWI 7/8	1250	111	68	22	34	11	0.47
VLWI 10	2000	133	86	27	40	12	0.87
VLWI 13	3200	169	108	32	52	16	1.85
VLWI 16	5000	204	134	38	64	20	3.40

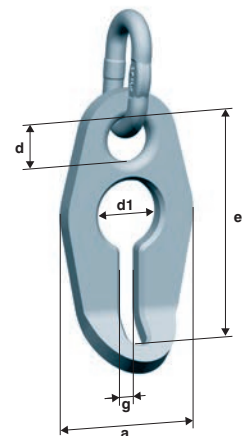

## BEAVER GRADE 50 CHAIN AND COMPONENTS (CONT'D)

### Beaver Stainless Steel Multi Link Assembly Grade 50 G316

Code	Chain Size mm	W.L.L (kg)	S mm	E mm	R mm	F mm	T mm	s mm	r mm	f mm	t mm	Approx Weight (kg)	UOM	Pack Qty
VWI5	5	1050	13	154	110	60	10	10	44	20	-	0.52	Each	10
VWI7	7	3200	23	230	160	90	17	16	70	34	14	2.32	Each	10
VWI10	10	5000	27	265	180	100	20	20	85	40	-	3.68	Each	10
VWI13	13	7100	33	315	200	110	26	23	115	50	17	6.46	Each	5
VWI16	16	10500	36	400	260	140	29	27	140	65	20	10.06	Each	5

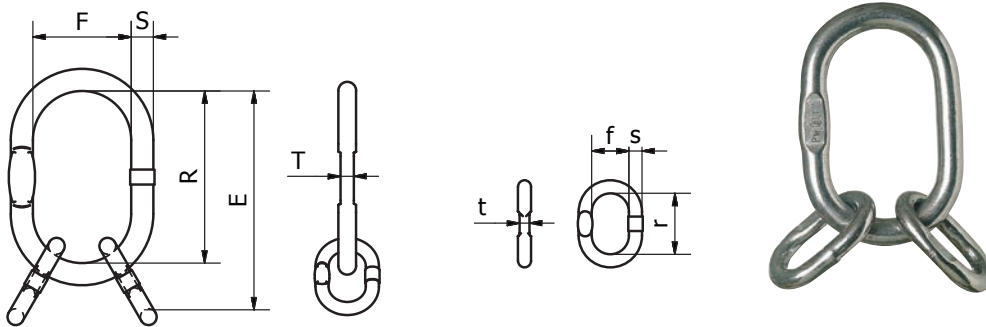

### Beaver Stainless Steel Connecting Link Grade 50 G316

Code	Chain Size mm	W.L.L (kg)	e mm	c mm	b mm	g mm	s mm	d mm	Approx Weight (kg)	UOM	Pack Qty	Replacement Pin
CWI5	5	500	36	7	34.4	12.7	9.5	7	0.05	Each	50	CBHWI5
CWI7	7	1000	54	9	50.8	16.6	13	9	0.12	Each	50	CBHWI7
CWI10	10	2000	73	13	69.8	24.6	18	13	0.33	Each	50	CBHWI10
CWI13	13	3200	92	17	85.4	28.6	23	17	0.7	Each	20	CBHWI13
CWI16	16	5000	104	21	105.3	36.5	28	21	1.22	Each	20	CBHWI16

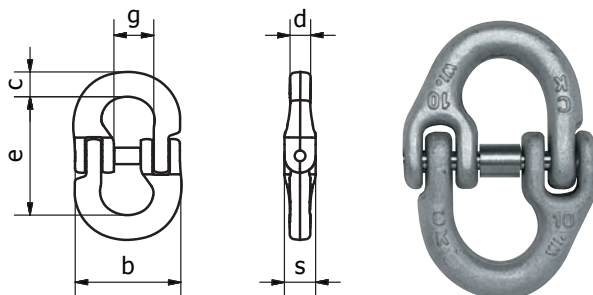

## Beaver Stainless Steel Eye Sling Hook c/w Safety Latch Grade 50

Code	Chain Size mm	W.L.L (kg)	e mm	h mm	d1 mm	d2 mm	b mm	g mm	Approx Weight (kg)	UOM	Pack Qty	Replacement Pin
HSK5	5	500	80	20	21	8	66	22	0.25	Each	1	SFGWI5
HSK7	7	1000	104	28	24	11	90	29	0.6	Each	1	SFGWI7
HSK10	10	2000	125	33	31	14	108	35	1.2	Each	1	SFGWI10
HSK13	13	3200	155	43	39	17	134	43	2.1	Each	1	SFGWI13
HSK16	16	4500	175	47.4	47	22	152.5	48	3	Each	1	SFGWI16

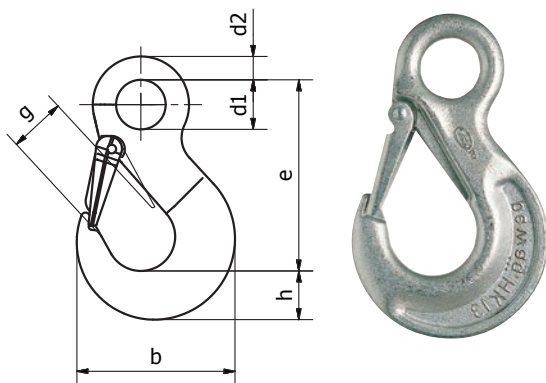

## Beaver- Grade '50' Screw Pin Shackles

Chain Dee Type

Code	Size mm	W.L.L (kg)	Type	Shape	Closing Method	DIA d	D mm	W mm	L mm	F mm	Approx Weight (kg)	UOM	Pack Qty
SMSWI4/5	8x9	500	Grade 50	Dee	Screw Pin	8	9	17	22	18	0.07	Each	30
SMSWI6/7/8	12x13	1250	Grade 50	Dee	Screw Pin	12	13	25	40	25	0.22	Each	30
SMSWI10	16x17	2000	Grade 50	Dee	Screw Pin	16	17	32	60	32	0.52	Each	30
SMSWI13	13x16	3200	Grade 50	Dee	Screw Pin	13	16	25	50	32	0.35	Each	10
SMSWI16	16x19	5000	Grade 50	Dee	Screw Pin	16	19	32	64	38	0.55	Each	10

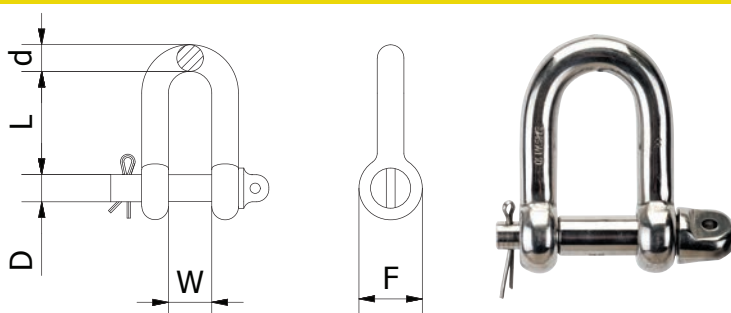



## PRODUCT REFERENCE GUIDE

Part Number	Page Number	Part Number	Page Number	Part Number	Page Number	Part Number	Page Number
148006	10	885307	16	886510	18	885732Y	17
148007	10	885310	16	886513	18	886213S	14
148008	10	885313	16	886516	18	886216S	14
148010	10	885316	16	886520	18	886406Y	15
148013	10	885320	16	886606	18	886407Y	15
148016	10	885322	16	886607	18	886410Y	15
148020	10	885326	16	886610	18	886413Y	15
148022	10	885332	16	886613	18	886416Y	15
148026	10	885407	18	886616	18	886420Y	15
148032	10	885410	18	886620	18	886422Y	15
263920	20	885413	18	886708	20	886426Y	15
882007	12	885416	18	886710	20	886701A	20
882010	12	885607	17	888807	19	886703A	20
882013	12	885610	17	888810	19	886705A	20
882016	12	885613	17	888813	19	886845L	19
883707	11	885616	17	883508A	10	886845R	19
883708	11	885620	17	883510A	10	AW16	27
883710	11	885622	17	883513A	10	AW18	27
883713	11	885806	16	883516A	10	AW22	27
883716	11	885807	16	883520A	10	AW26	27
883720	11	885810	16	883522A	10	AW32	27
883722	11	885813	16	883526A	10	AW36	27
883726	11	885816	16	883532A	10	AW45	27
883732	11	885820	16	883536A	10	AW50	27
884507	13	885822	16	884510SY	13	AW56	27
884510	13	885826	16	884513SY	13	AW72	27
884513	13	885832	16	884516SY	13	AWI10	41
885106	15	886206	14	885706Y	17	AWI13	41
885107	15	886207	14	885707Y	17	AWI16	41
885110	15	886210	14	885710Y	17	AWI18	41
885113	15	886213	14	885713Y	17	AWI22	41
885116	15	886216	14	885716Y	17	AWI26	41
885120	15	886220	14	885720Y	17	BALPV015	35
885122	15	886222	14	885722Y	17	BALPV025	35
885306	16	886507	18	885726Y	17	BALPV040	35



# LIFTING CHAIN AND COMPONENTS

# SECTION 2

Part Number	Page Number	Part Number	Page Number	Part Number	Page Number	Part Number	Page Number
BALPV067	35	CSA08127525	8	CSA13237545	9	G1-CSA08267525	24
BALPV100	35	CSA08127545	9	CSA13247525	8	G1-CSA08267545	25
BALPV160	35	CSA08137525	8	CSA13247545	9	G1-CSA10117525	24
BRLP- 1/2UNC	36	CSA08137545	9	CW6	29	G1-CSA10117545	25
BRLP-M12	36	CSA08217525	8	CW8	29	G1-CSA10127525	24
BRLP-M16	36	CSA08217545	9	CW10	29	G1-CSA10127545	25
BRLP-M20	36	CSA08227525	8	CW13	29	G1-CSA10137525	24
BRLP-M24	36	CSA08227545	9	CW16	29	G1-CSA10137545	25
BRLP-M30	36	CSA08237525	8	CW20	29	G1-CSA10217525	24
BRLP-M36	36	CSA08237545	9	CW22	29	G1-CSA10217545	25
BRLP-M42	36	CSA08247525	8	CW26	29	G1-CSA10227525	24
C6	12	CSA08247545	9	CW32	29	G1-CSA10227545	25
C7	12	CSA08267525	8	CWI10	42	G1-CSA10237525	24
C8	12	CSA08267545	9	CWI13	42	G1-CSA10237545	25
C10	12	CSA10117525	8	CWI16	42	G1-CSA10247525	24
C13	12	CSA10117545	9	CWI5	42	G1-CSA10247545	25
C16	12	CSA10127525	8	CWI7	42	G1-CSA10267525	24
C20	12	CSA10127545	9	FW10	34	G1-CSA10267545	25
C22	12	CSA10137525	8	FW13	34	G1-CSA13217525	24
C26	12	CSA10137545	9	FW16	34	G1-CSA13217545	25
C32	12	CSA10217525	8	FW20	34	G1-CSA13227525	24
CSA07117525	8	CSA10217545	9	G1-CSA08117525	24	G1-CSA13227545	25
CSA07117545	9	CSA10227525	8	G1-CSA08117545	25	G1-CSA13237525	24
CSA07127525	8	CSA10227545	9	G1-CSA08127525	24	G1-CSA13237545	25
CSA07127545	9	CSA10237525	8	G1-CSA08127545	25	G1-CSA13247525	24
CSA07137525	8	CSA10237545	9	G1-CSA08137525	24	G1-CSA13247545	25
CSA07137545	9	CSA10247525	8	G1-CSA08137545	25	G5-CSA07117535	40
CSA07217525	8	CSA10247545	9	G1-CSA08217525	24	G5-CSA07127535	40
CSA07217545	9	CSA10267525	8	G1-CSA08217545	25	G5-CSA07137535	40
CSA07227525	8	CSA10267545	9	G1-CSA08227525	24	G5-CSA07217535	40
CSA07227545	9	CSA13217525	8	G1-CSA08227545	25	G5-CSA07227535	40
CSA07237525	8	CSA13217545	9	G1-CSA08237525	24	G5-CSA07237535	40
CSA07237545	9	CSA13227525	8	G1-CSA08237545	25	G5-CSA10117535	40
CSA08117525	8	CSA13227545	9	G1-CSA08247525	24	G5-CSA10127535	40
CSA08117545	9	CSA13237525	8	G1-CSA08247545	25	G5-CSA10137535	40

## PRODUCT REFERENCE GUIDE

Part Number	Page Number	Part Number	Page Number	Part Number	Page Number	Part Number	Page Number
G5-CSA10217535	40	KLHW19-20	31	PW20	32	VWI7	42
G5-CSA10227535	40	KLHW22	31	PW22	32	VWI10	42
G5-CSA10237535	40	KLHW26	31	PW26	32	VWI13	42
G5-CSA10247535	40	KPW6	30	PW32	32	VWI16	42
G5-CSA10267535	40	KPW8	30	SMSWI4/5	43	WIN6	26
G5-CSA13217535	40	KPW10	30	SMSWI6/7/8	43	WIN8	26
G5-CSA13227535	40	KPW13	30	SMSWI10	43	WIN10	26
G5-CSA13237535	40	KPW16	30	SMSWI13	43	WIN13	26
G5-CSA13247535	40	KPW20	30	SMSWI16	43	WIN16	26
HSK5	43	KPW22	30	VLW2-8	27	WIN20	26
HSK7	43	LHW7-8	33	VLW2-10	27	WIN22	26
HSK10	43	LHW10	33	VLW2-13	27	WIN26	26
HSK13	43	LHW13	33	VLW2-16	27	WIN32	26
HSK16	43	LHW16	33	VLWI 7/8	41	WOX5	41
HSW8	33	LHW19-20	33	VLWI 10	41	WOX7	41
HSW10	33	LHW22	33	VLWI 13	41	WOX10	41
HSW13	33	MW10	26	VLWI 16	41	WOX13	41
HSW16	33	MW13	26	VLWI 5/6	41		
HSW20	33	MW16	26	VMW7-8	29		
HSW22	33	MW18	26	VMW10	29		
HSW26	33	MW22	26	VMW13	29		
HSW32	33	MW26	26	VMW16	29		
KHSW6	31	MW32	26	VMW20	29		
KHSW8	31	MW36	26	VMW22	29		
KHSW10	31	MW56	26	VW7-8	28		
KHSW13	31	PSW7-8	32	VW10	28		
KHSW16	31	PSW10	32	VW13	28		
KHSW20	31	PSW13	32	VW16	28		
KHSW22	31	PSW16	32	VW20	28		
KLHW8	31	PW8	32	VW22	28		
KLHW10	31	PW10	32	VW26	28		
KLHW13	31	PW13	32	VW32	28		
KLHW16	31	PW16	32	VWI5	42		

**LIFTING CHAIN AND COMPONENTS**

SECTION  
**2**





**NATIONAL HEAD OFFICE  
NEW SOUTH WALES**

Email: [sydneysales@beaver.com.au](mailto:sydneysales@beaver.com.au)  
National Sales: 1300 783 606  
Phone: (02) 8882 5700  
Fax: (02) 8882 5899

55 Sarah Andrews Close  
Erskine Park NSW 2759  
PO Box 5001  
St Clair NSW 2759

**WESTERN AUSTRALIA**

Email: [perthsales@beaver.com.au](mailto:perthsales@beaver.com.au)  
Ph: (02) 8882 5700

**VICTORIA/ TASMANIA**

Email: [melbournesales@beaver.com.au](mailto:melbournesales@beaver.com.au)  
Ph: (02) 8882 5700

**SOUTH AUSTRALIA/  
NORTHERN TERRITORY**

Email: [adelaidesales@beaver.com.au](mailto:adelaidesales@beaver.com.au)  
Ph: (08) 8244 3555  
Fax: (08) 8244 3533

**QUEENSLAND**

Email: [brisbanesales@beaver.com.au](mailto:brisbanesales@beaver.com.au)  
Ph: (07) 3279 1100  
Fax: (07) 3279 1381

[www.beaver.com.au](http://www.beaver.com.au)

Specifications and dimensions are subject to change without notice  
© Copyright Beaver Brands 2015